

9" | **902 SERIES**
VGA/HDMI/VIDEO LCD Monitor

902 SERIES

VGA/HDMI/VIDEO LCD Monitor

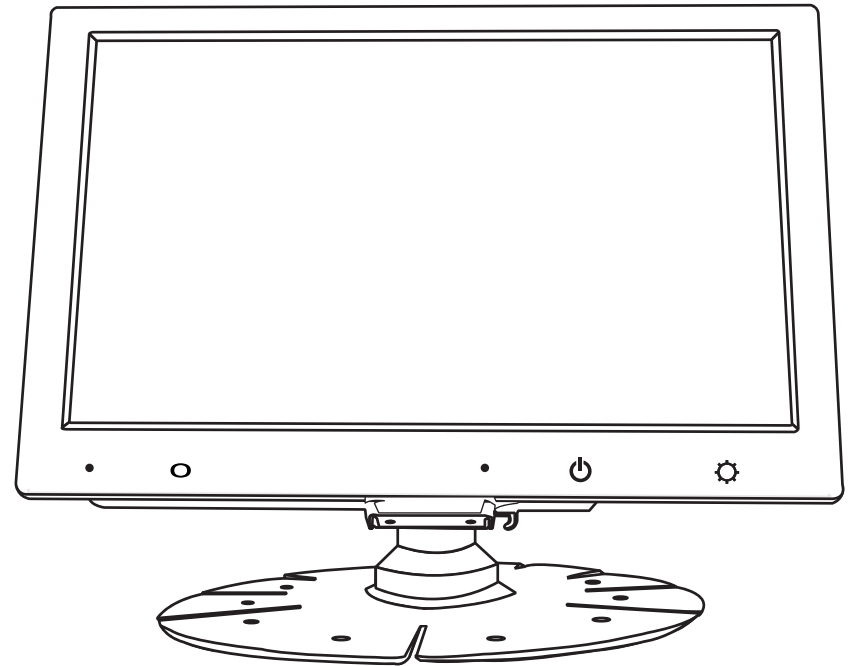

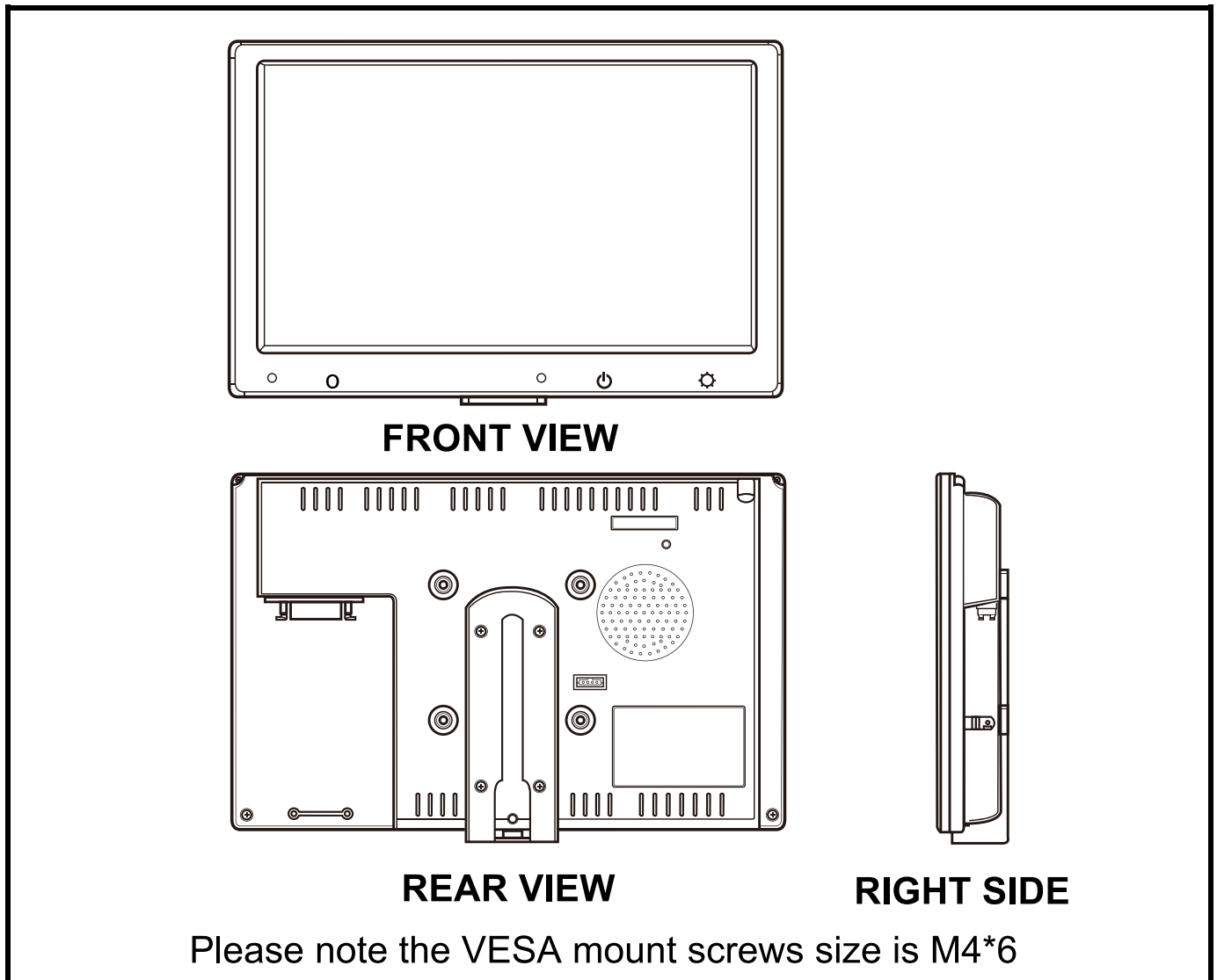

Touch Screen Monitor



1. External Buttons, Hot Key description:



-  **POWER:** Long Press (About 3 Sec.) to turn ON or OFF the Monitor
Short Press (About 1 sec.) for input source selection (While Screen is On)
-  **Dimmer:** This controls display brightness for optimum viewing. Following this rotation:
Dimmer Dark -> Dimmer Middle -> Dimmer Bright -> Dimmer Auto

The OSD menus can be operated by using the remote control. (See “Remote Control” on page 3)

2. Contents

- 26PIN Multi Signal Cable (VGA/HDMI/VIDEO1/VIDEO2/USB)
- 12VDC, 1.5A Power Adaptor
- Cigarette Lighter Adaptor
- Universal Stand
- IR Remote Control
- CD Driver for Touch screen

3. Steps to install the monitor

- (1.) Plug the Power Adaptor for the monitor into a nearby outlet.
Connect the barrel plug to the power port at the rear of the monitor.
- (2.) Attach the 26-Pin connector to the monitor. Attach the D-Sub 15-Pin connector to your computer's analog VGA output connector. Attach the HDMI connector to your computer's HDMI output connector. Attach your "Video source one" (e.g. VCR, Video Game Console) to the Yellow RCA connector marked Video 1. Attached your "Video source two" (e.g. Rear View Camera) to the Yellow RCA connector marked CCD. Attach your "audio sources" to the red RCA Connectors marked Audio. Attach the mini stereo jack marked "PC Audio" to your computer's earphone jack.
- (3.) Connect the USB cable to the USB port of the PC.
- (4.) Install Touchscreen driver:

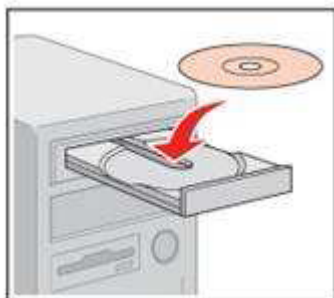

Please use Touch Tools CD + Quick Install Guide for installation

Touch Screen Monitor

4. Remote Control

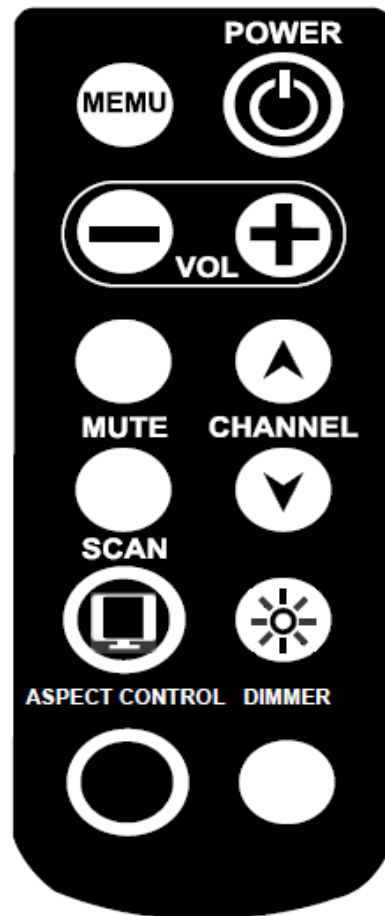

4.1 Remote Control Key Index

	KEY	Description
1	POWER	Turns the LCD display ON or OFF
2	MENU	Turns the OSD Menu on and off, or to exit a sub-menu.
3	VOL +	Increases the volume or the value of setting inside the OSD menu.
4	VOL -	Decreases the volume or the value of setting inside the OSD menu.
5	CHANNEL ↑	· To switch the panel UP/DOWN (Vertical Image Flip) · Press ↑ and ↓ to select the option while the OSD menu is on.
6	CHANNEL ↓	· To switch the panel Left/Right (Mirror Image Flip) · Press ↑ and ↓ to select the option while the OSD menu is on.
7	MUTE	Turns the sound on and off.
8	SCAN	Selects the display source for the main screen. (VGA/HDMI/ Video1/ Video2 mode)
9	DIMMER	Dimmer control. Control display brightness for Optimum viewing , following the rotation: Dimmer Dark -> Middle -> Bright -> Auto
10	ASPECT CONTROL	Change aspect ratio to 16:9 or 4:3
11		Non-Functional
12		Non-Functional

Menu Adjustment

Press Menu button to enter the main menu, then the menu will display on the monitor.

Use “Channel UP/Down” to highlight the menu option, then use “VOL +/VOL –” button to set or adjust the setting. Please press Menu button to EXIT after finishing adjustment.

Sub-Menu Option

Menu contains sub-menu settings. Press menu button to enter the main menu, then use “VOL +/VOL –” Button to enter sub-menu.

OSD Menu Organization & Adjustment

5. Adjusting Settings

This Chapter explains the LCD display’s On-Screen-Display (OSD) menus. These are used to adjust settings related to picture quality in PC/HDMI/Video1/Video2 Modes.

5.1 OSD Main Menu For PC/VGA Mode

5.1.1 In VGA Input Mode: (PC/VGA)

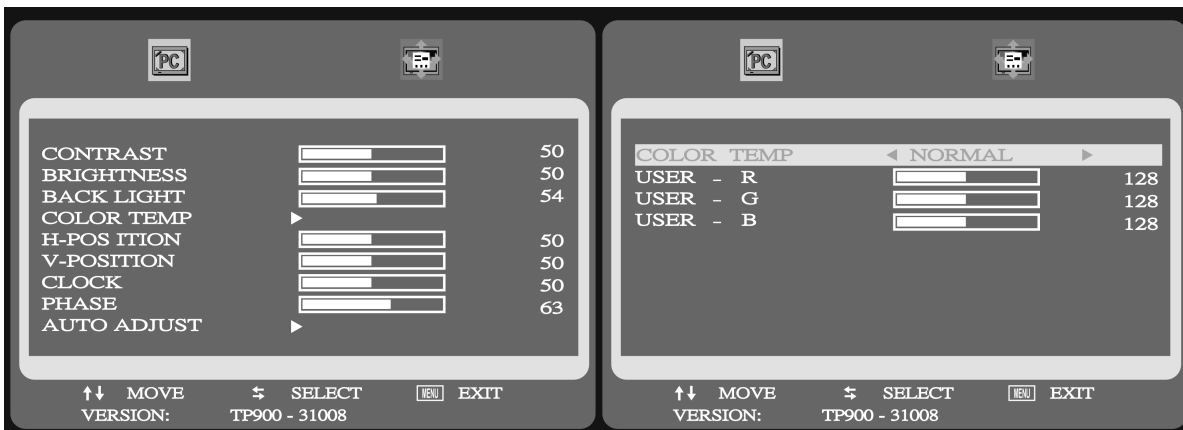

1. Contrast

- Adjust the contrast ratio between Min (0) and MAX (100).

2. Brightness

- Adjust the brightness level of the screen between Min (0) and MAX (100).

3. Backlight

- Adjust the luminance level of the screen between Min (0) and MAX (100).

4. Color Temp → Please enter Submenu to select.

- Select the setting (4 modes: Warn / Cold / User / Normal) of screen color to be reddish white or bluish white. This item controls the color temperature:

Touch Screen Monitor

- A. Warn Mode** User - R 136; User - G 128; User - B 128
- B. Cold Mode** User - R 128; User - G 128; User - B 136
- C. User Mode** – This item controls the Red, Green, and Blue Gain ; select between Min (0) and MAX (255).
- D. Normal Mode** User - R 128; User - G 128; User - B 128

5. H- Position

- Shift the screen left or right between Min (0) and MAX (100).

6. V- Position

- Shift the screen up or down between Min (0) and MAX (100).

7. Clock

- Adjust the monitor internal sampling clock rate between Min (0) and MAX (100).

8. PHASE

- Adjust the monitor internal signal phase between Min (0) and MAX (100).

9. Auto Adjust

- Optimize the picture performance automatically.

5.1.2 In VGA/HDMI/Video1/Video2 Input Mode: (Common)

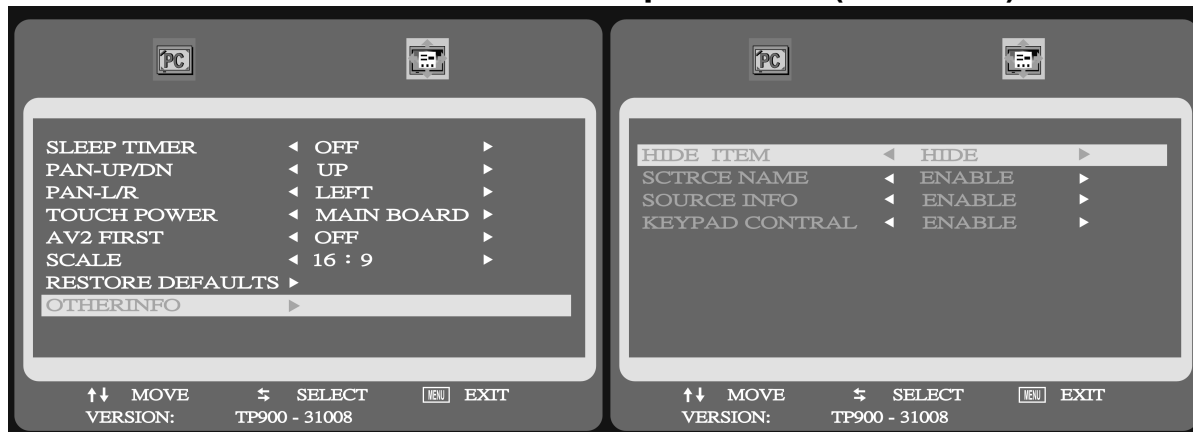

1. Sleep Timer

- This option controls OSD window with OFF / 15 / 30 / 45 /60 sec. timer

2. PAN-UP/DN

- Vertical Image Flip. This function flips the display upside down.

3. PAN-L/R

- Mirror Image Flip. This function mirrors the display.

4. Touch Power

- Select the power source of the touch control board.

5. AV2 First

- Set whether to have monitor switch to Video Input 2 automatically if a signal is present. Good for car reverse monitoring system. Default is No.

6. SCALE

- Set the display mode to 16:9 or 4:3. Set it to 4:3 if your video signal is in 4:3 aspect ratio and you don't want the display to be stretched out. Default is 16:9.

7. Restore defaults

- Reset all settings to factory default setting.

8. Other Info → Please enter Sub-menu to select.

- Select to Enable or Disable the specific menu items
(Source Name/ Source Info/ Keypad Control)

5.1.3 PC/VGA OSD Menu Organization

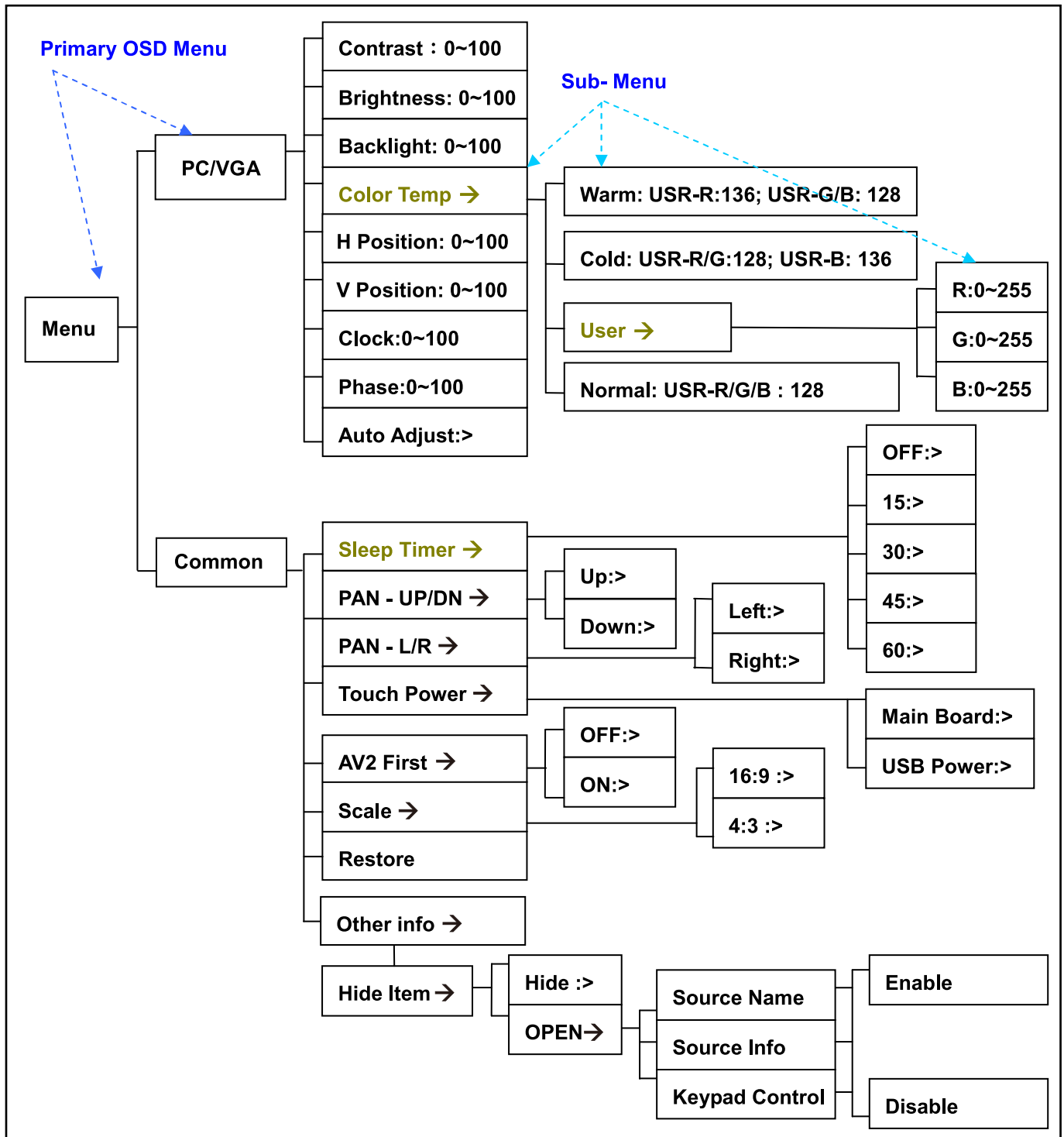

Touch Screen Monitor

5.2 OSD Main Menu For HDMI Mode

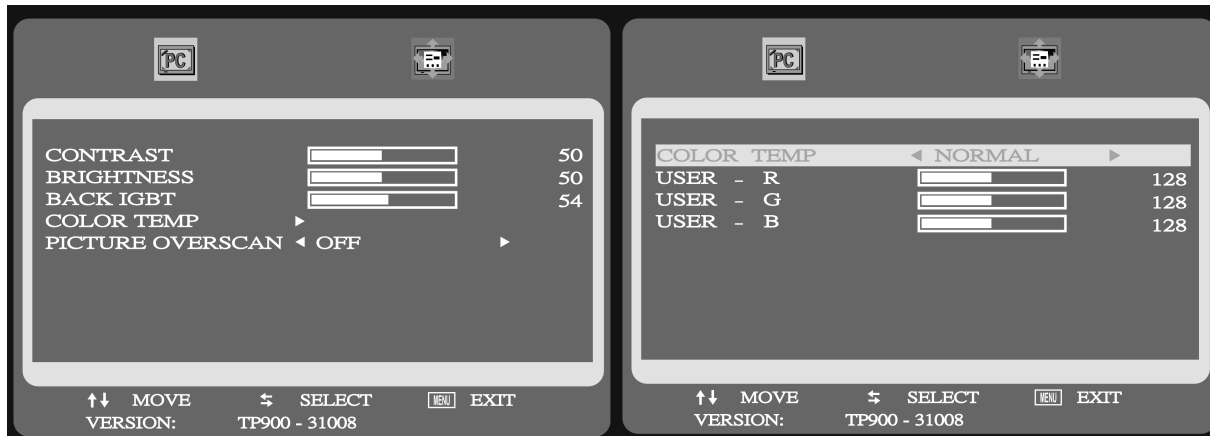

1. Contrast

- Adjust the contrast ratio between Min (0) and MAX (100).

2. Brightness

- Adjust the brightness level of the screen between Min (0) and MAX (100).

3. Backlight

- Adjust the luminance level of the screen between Min (0) and MAX (100).

4. Color Temp → Please enter Submenu to select.

- Select the setting (4 modes: Warn / Cold / User / Normal) of screen color to be reddish white or bluish white. This item controls the color temperature:

E. Warn Mode User - R 136; User - G 128; User - B 128

F. Cold Mode User - R 128; User - G 128; User - B 136

G. User Mode – This item controls the Red, Green, and Blue Gain ; select between Min (0) and MAX (255).

H. Normal Mode User - R 128; User - G 128; User - B 128

5. Picture Overscan

- Optimize the picture performance automatically.

5.2.1 HDMI OSD Menu Organization

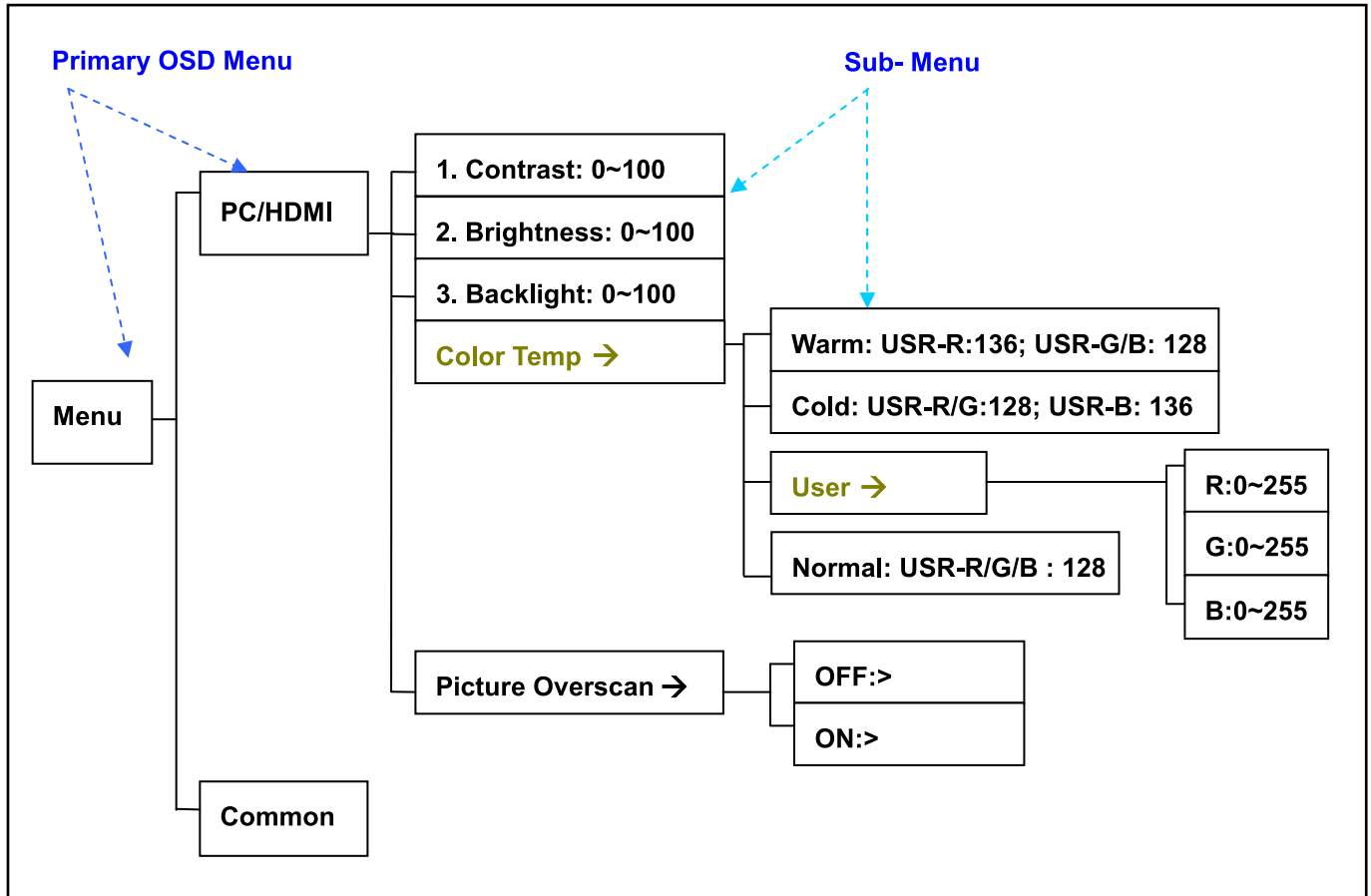

5.3 OSD Main Menu For Video1 & Video2 Mode

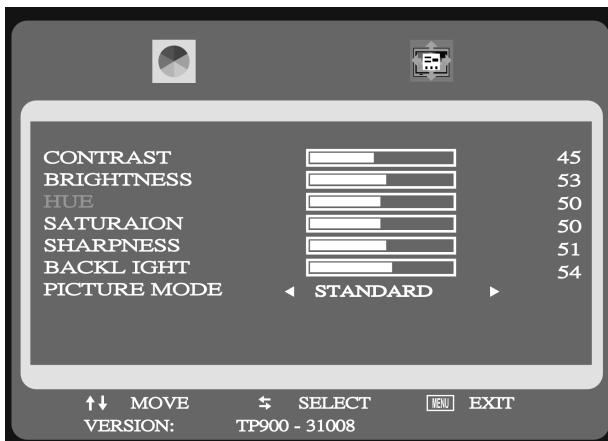

1. **Contrast**
 - Adjust the contrast ratio between Min (0) and MAX (100).
2. **Brightness**
 - Adjust the brightness level of the screen between Min (0) and MAX (100).
3. **Hue**
 - Setup the number level at (50), this item cannot be adjusted.
4. **Saturation**
 - This item controls Saturation between Min (0) and MAX (100).

Touch Screen Monitor

5. Sharpness

- This item controls the picture sharpness, sharpness select between Min (0) and MAX (100).

6. Backlight

- Adjust the luminance level of the screen between Min (0) and MAX (100).

7. Picture Mode

- Quick select of the picture mode setting (3 modes: Soft / Vivid / User /Standard),
Choice User Mode : Set your own picture mode, adjust above 1~6 items between Min (0) and MAX (100).

5.3.1 VIDEO(S) MODE

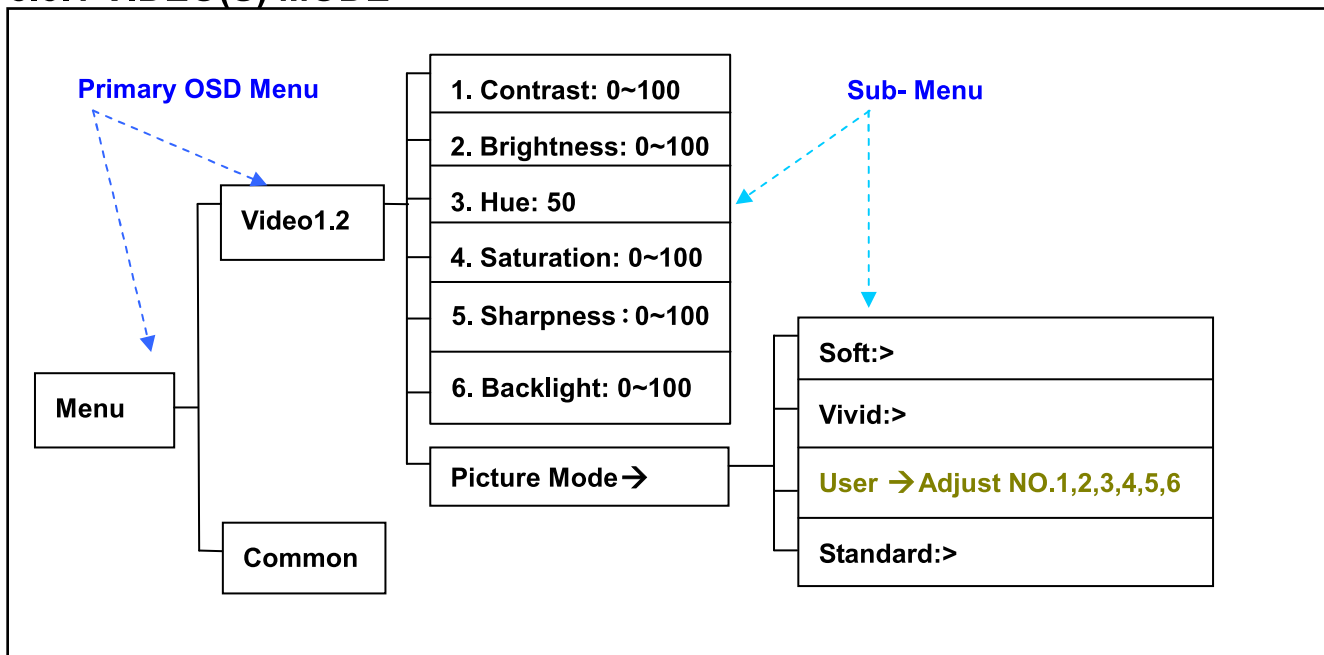

6.Specifications

Display Specifications

LCD Module	: 9" Digital TFT LCD
LCD Native resolution	: 1024RGB (W) x 600 (H)
Pixel Pitch	: 0.192(W) x 0.19025(H)
LCD Panel Brightness	: 1000 NIT
Contrast	: 500:1
Response Time	: 25ms
Viewing Angle	: Top:50/Bottom :70/Left:70/Right:70
Supported display resolution	: 640 x 480 ~ 1920 x 1080
Supported refresh rate	: 60 ~ 75 Hertz
Video Format	: NTSC/PAL Auto-detect

6.1 Physical Specifications

Video Source Input

- RGB analog male connector (15-Pin D-SUB) x 1
- RCA composite video female connector x 2
- HDMI A type male connector x 1

Audio Source Input

- RCA audio female connector x 1
- PC audio male connector x 1

Touch Panel I/O

- USB connector x 1

Power Source Input

- Single 12V DC_IN (Supports 11V ~ 32V)

External Buttons Input

- PWR button for power switch
- Dimmer for brightness adjustment

6.2 Electrical Specifications

Power Consumption:

Standby mode < 80mA

Suspend mode < 230mA/500mA/790mA

Continue mode < 860mA

6.3 Other Specifications

- Operation temperature: -20~+70
- CE, FCC certified
- ROHS Compliant